

**Traffic Improvements for the
Transit Oriented Development
District (TODD)**

Meriden Public Library

March 11, 2014

Project Overview

- Coordinate roadway improvements with other major projects
 - HUB
 - Flood Control
 - Train Station
 - Transit Oriented Development District Zoning
 - Housing (24 Colony Street, Record Journal Building)

Project Overview

- Implement two-way traffic on West Main Street / East Main Street, Cook Ave, Hanover Street and Perkins Square
 - Benefit downtown businesses
 - Improved traffic circulation
 - Pedestrian and bicycle networks
 - Better strategies for intracity and intercity bus travel



Project Overview

- Mitigate traffic impacts associated with High Speed Rail crossings
- Enhance Vehicular and Pedestrian Safety
- Enhance existing Streetscape
 - Brick pavers
 - Street trees
 - Pavement condition



Public Input

- Public informational meeting at Lincoln M.S.
- Public meeting at library
- Stakeholders Streetscape / Pedestrian / Biking
- Stakeholders Parking and Loading
- Business owners at Café Dolce
- Parking Authority and Police Department
- Wells Fargo

The background of the slide features a large, light-colored watermark of the University of Maryland seal. The seal is circular and contains the text "UNIVERSITY OF MARYLAND" at the top and "MDCCCLXVII" at the bottom. In the center, there is a shield with a ship and a plow, flanked by two figures. The shield is surrounded by a laurel wreath and three stars.

Challenges

- **Physical Constraints**
 - Limited Right of Way
 - Utilities
 - Railroad crossings

The background of the slide features a large, light-colored watermark of the University of Maryland seal. The seal is circular and contains a shield with a ship, a plow, and a sheaf of wheat. Above the shield is a crest with a book and a quill. The seal is surrounded by a laurel wreath and the text "UNIVERSITY OF MARYLAND" at the top and "MDCCCLXVII" at the bottom.

Challenges

- **Competing interests**
 - Motorists
 - Parking
 - Public transportation
 - Pedestrians
 - Bicyclists
 - Businesses

The background of the slide features a large, light-colored watermark of the University of Maryland seal. The seal is circular and contains a shield with a ship, a plow, and a sheaf of wheat. Above the shield is a crest with a figure holding a staff. The seal is surrounded by a laurel wreath and the text "UNIVERSITY OF MARYLAND" at the top and "MDCCCLXVII" at the bottom.

Challenges

- **Parking and Loading Management**
 - On-street
 - Off-Street
 - Loading zones
 - Bus stops



Challenges

- Maintenance
 - Design an attractive downtown
 - Minimize long-term maintenance costs
- Funding
 - Identify sources of \$\$\$
 - Significant costs
 - Work within existing curb saves \$\$
 - Minimize acquisitions

We get one shot at this. Let's do it right.



Streetscape Elements – Preliminary Design

- Roadway configuration
 - Changing One-Way Streets to Two-Way Streets
 - Curb Extensions
 - Raised Medians
 - Wide travel lanes to accommodate bicycles



Streetscape Elements – Preliminary Design

- Pedestrian Facilities
 - Mid-Block Crosswalks
 - Pedestrian & Bicycle Crossing Signals
 - Pedestrian Refuge Islands
 - Shared Use Trails
 - Countdown Signals
- Bicycle Facilities
 - Shared Lane Markings
 - Parking



Streetscape Elements – Final Design

- Visual Treatments
 - Sidewalks
 - Replacement of bricks with standard concrete
 - Color at key locations / interest centers / intersections
 - Maintain “Personalized” Bricks
 - Crosswalks
 - High Visibility Crosswalks
 - Stamped concrete
 - Bus stops / loading zones
 - Differentiated with textured pavement

Mid-Block Crosswalks



Location: Hartford, CT, USA
Photo Credit: Dave Sousa

High Visibility Crosswalks



Location: Portsmouth, NH, USA
Photo Credit: Dave Sousa



Location: Williamstown, MA, USA
Photo Credit: Dave Sousa



Location: Albany, NY, USA
Photo Credit: Dave Sousa

Curb Extensions (Bulb-outs)

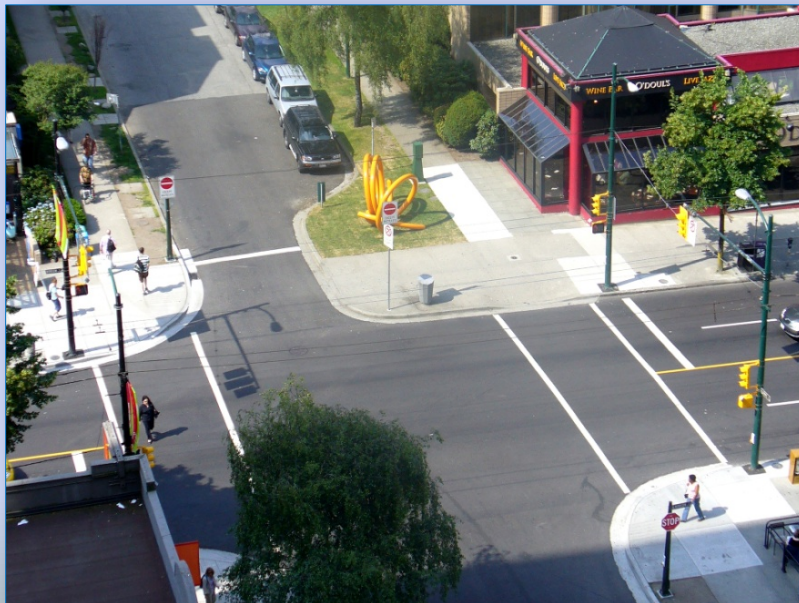

Location: Vancouver, BC, Canada
Photo Credit: Dave Sousa

Raised Medians / Pedestrian Refuge Islands



Location: Unknown
Photo Credit: Dan Burden, Walkable Communities



Location: Banff, B.C., Canada
Photo Credit: Dave Sousa



Location: West Hartford, CT
Photo Credit: Dave Sousa

Shared Use Trails



Location: Florence , Italy
Photo Credit: Dave Sousa



Location: Simsbury, CT
Photo Credit: Dave Sousa

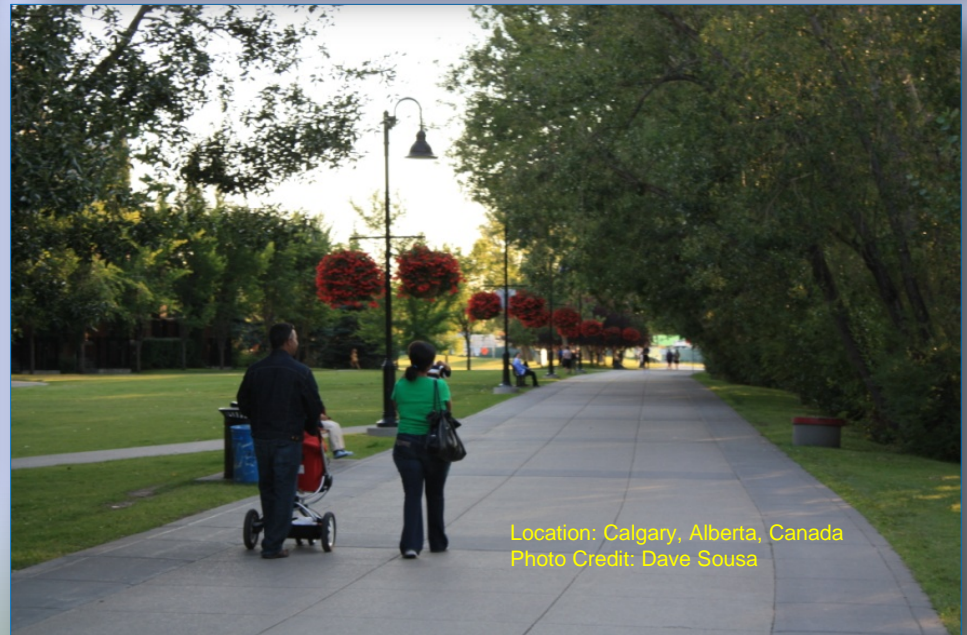

Location: Calgary, Alberta, Canada
Photo Credit: Dave Sousa

Proposed Improvements

MAJOR IMPROVEMENTS

- Cook Ave
- West Main Street
- East Main Street
- Hanover Street
- Perkins Square
- Pratt Street
- Colony Street

LEGEND

RED - New Concrete

DARK BLUE - Removal

GREEN - Ped / Bike

LT BLUE - Parking

ORANGE - Bus / Loading

Cook Avenue

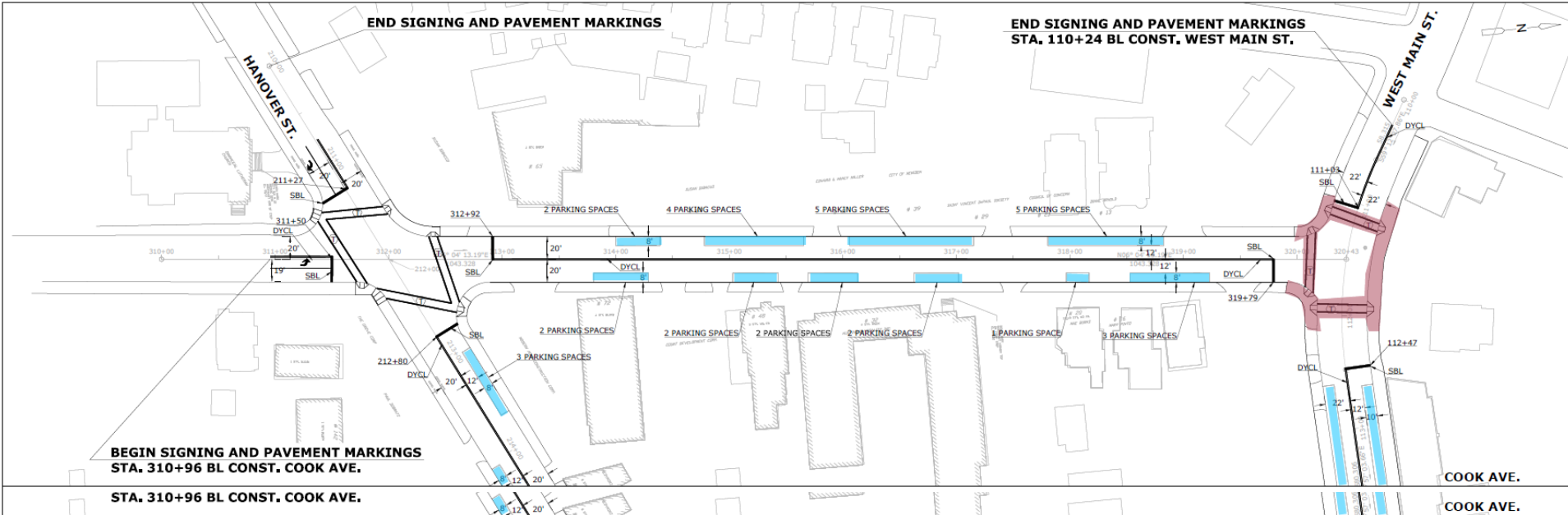
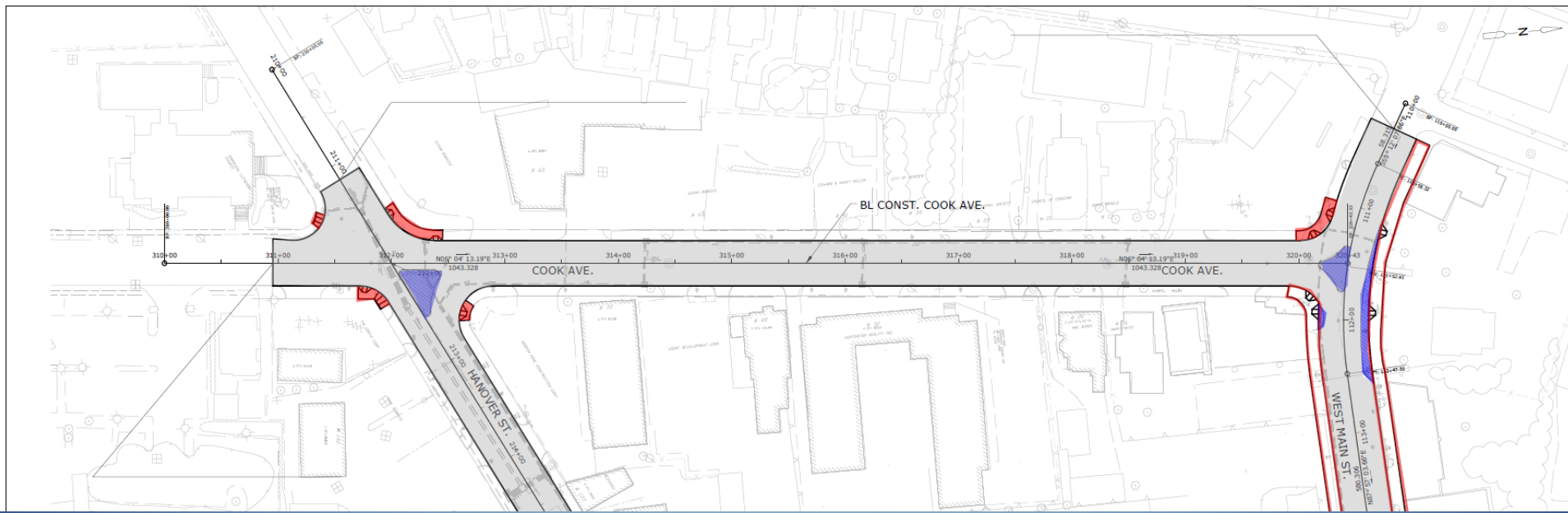

West Main Street

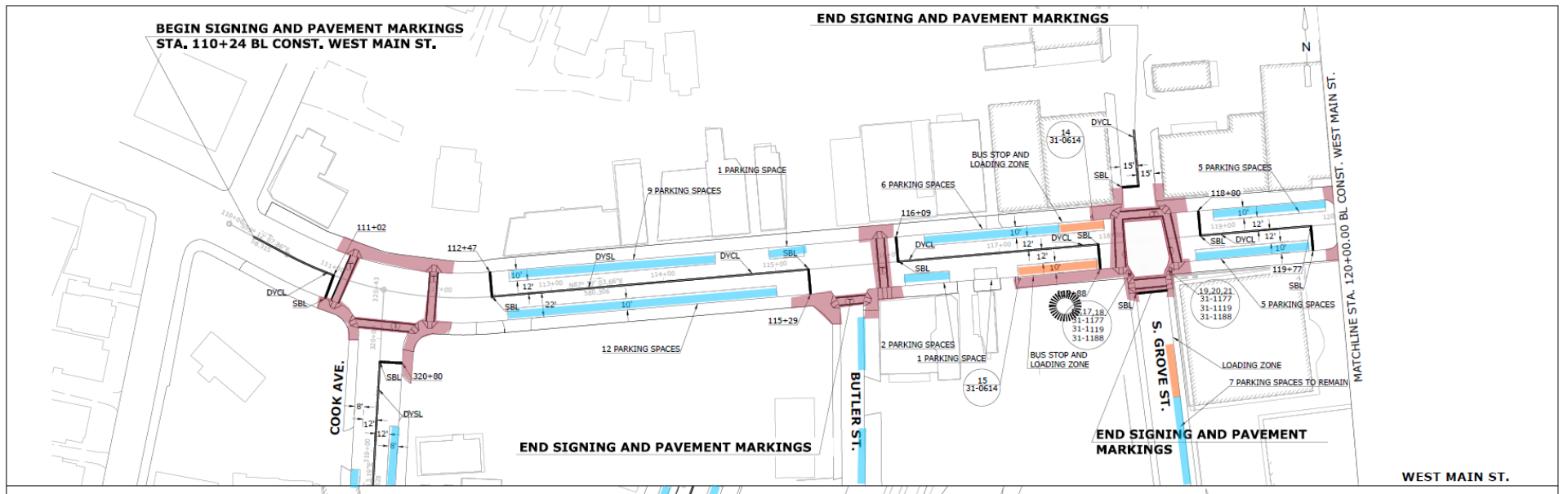
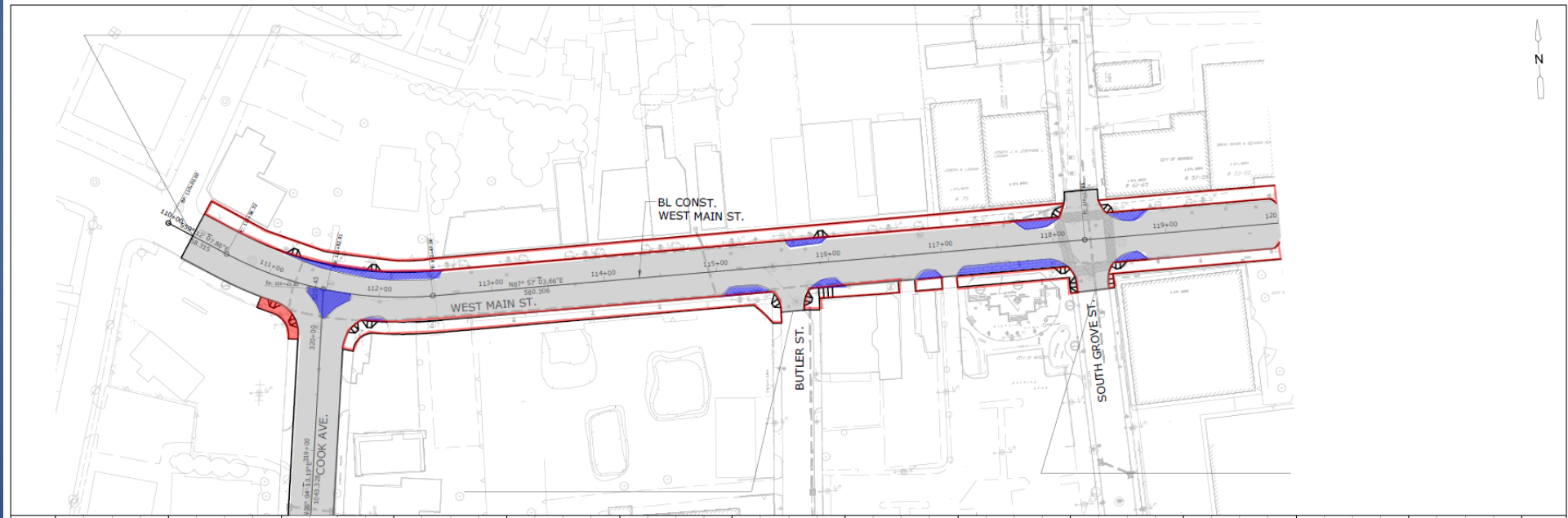

West Main Street / East Main Street

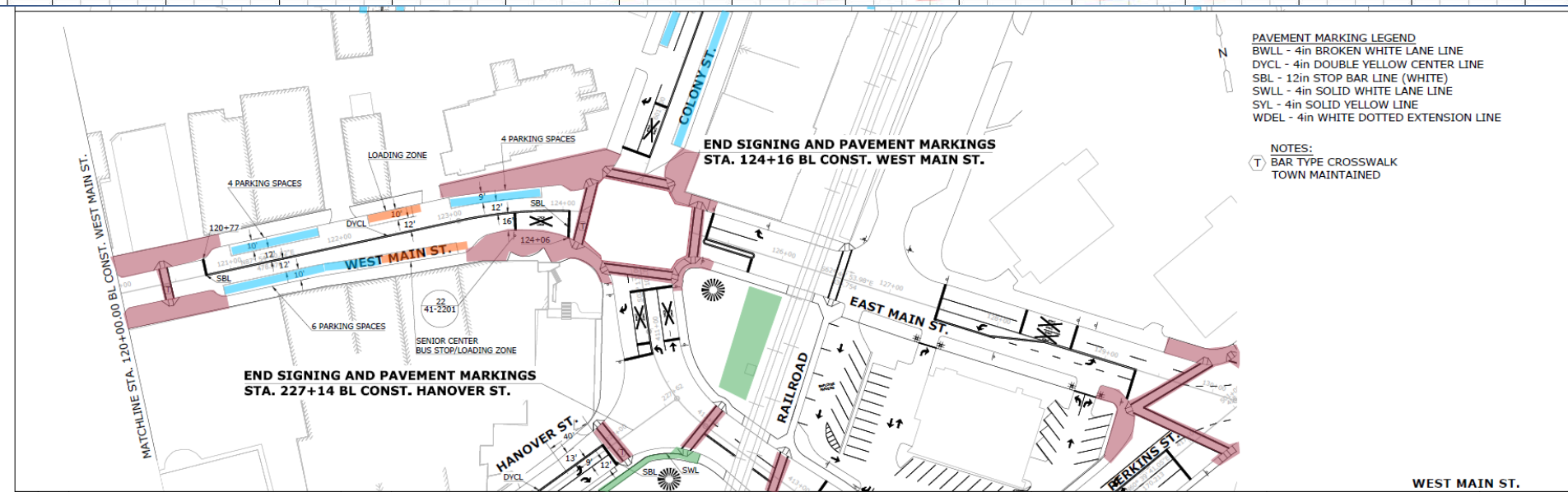
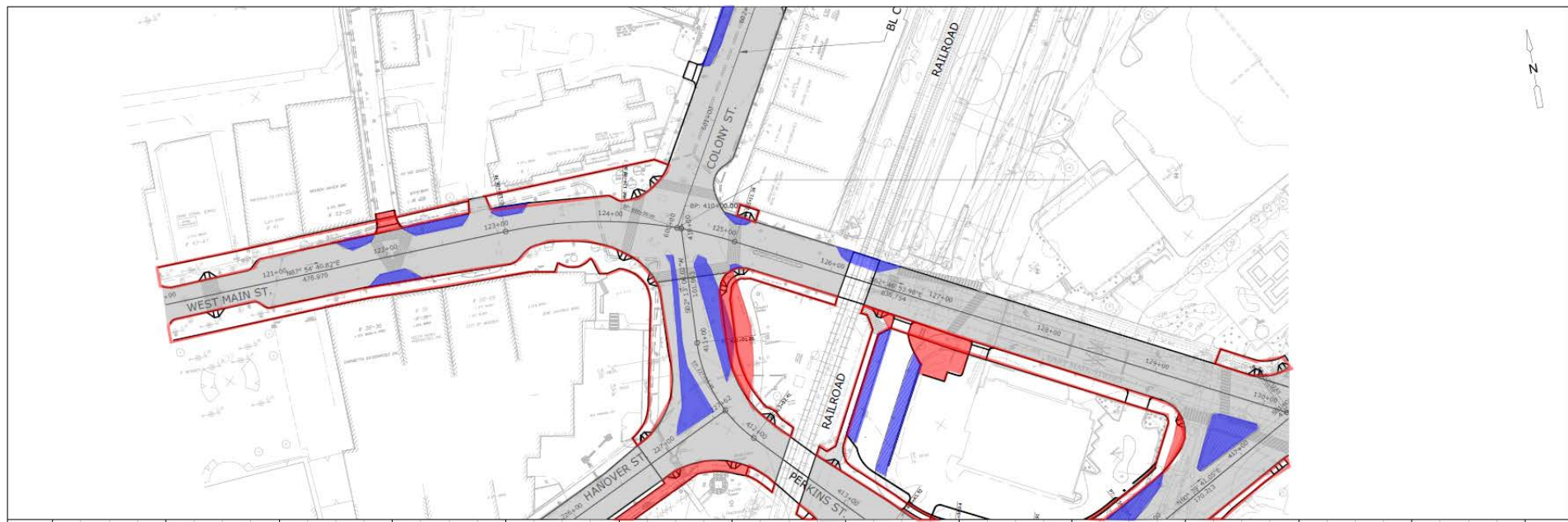

- PAVEMENT MARKING LEGEND**
- BWLL - 4in BROKEN WHITE LANE LINE
 - DWCL - 4in DOUBLE YELLOW CENTER LINE
 - SBL - 12in STOP BAR LINE (WHITE)
 - SWL - 4in SOLID WHITE LANE LINE
 - SYL - 4in SOLID YELLOW LINE
 - WDEL - 4in WHITE DOTTED EXTENSION LINE

- NOTES:**
- T BAR TYPE CROSSWALK TOWN MAINTAINED

East Main Street

END WEST MAIN ST. STA. 124+63.00
BEGIN EAST MAIN ST. STA. 124+63.00
SEE WEST MAIN ST. PLAN AND
PROFILE SHEET FOR CONTINUITY.

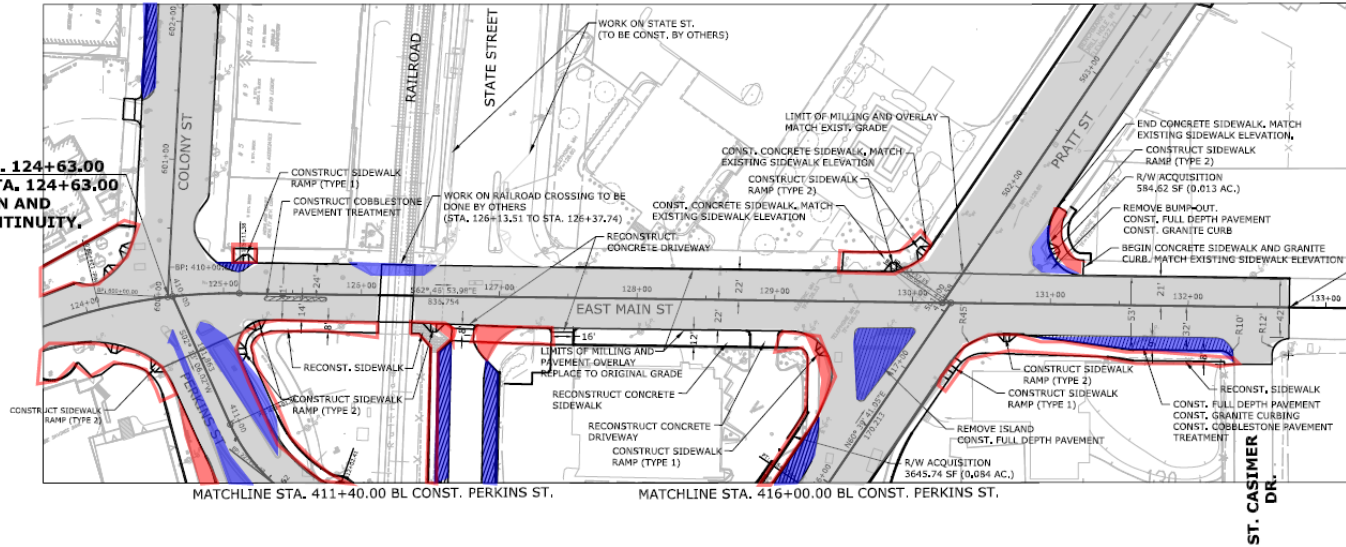

END SIGNING AND
PAVEMENT MARKINGS
STA. 124+16 BL CONST.
WEST MAIN ST.

END SIGNING AND PAVEMENT MARKINGS
STA. 501+25 BL CONST. PRATT ST.

LOSS OF 4 PARKING SPACES
 TO ACCOMMODATE WIDER INTERSECTION
 RADIUS AND ALLOW FOR THROUGH LANE.

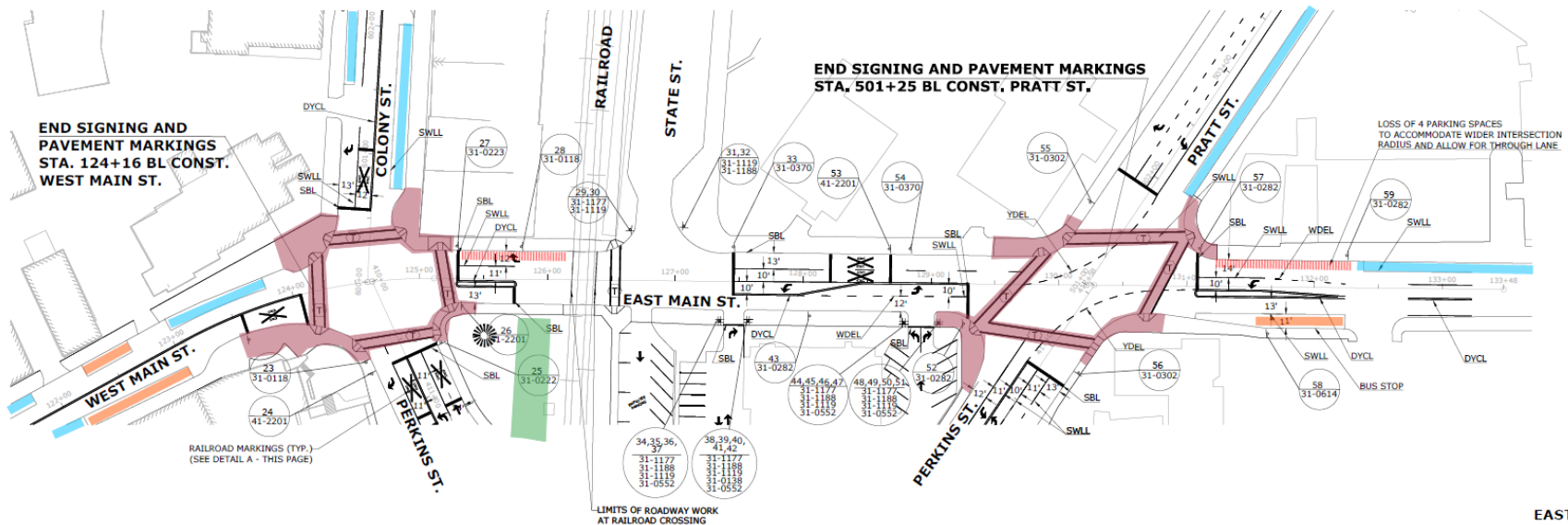

EAST MAIN ST.

Hanover Street

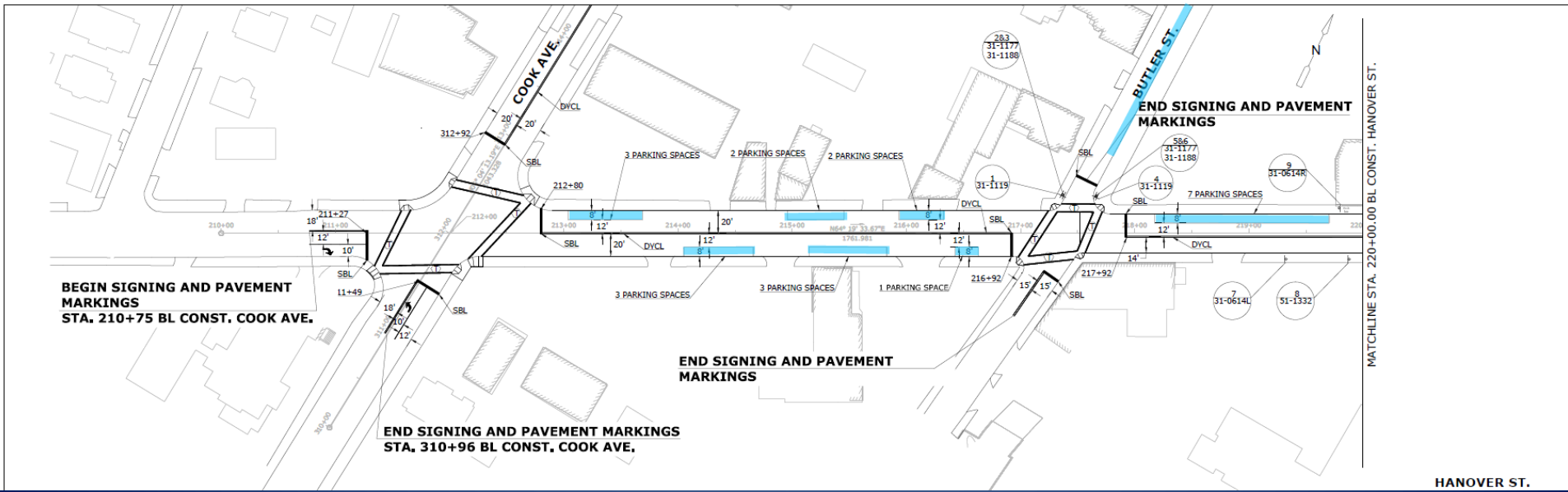
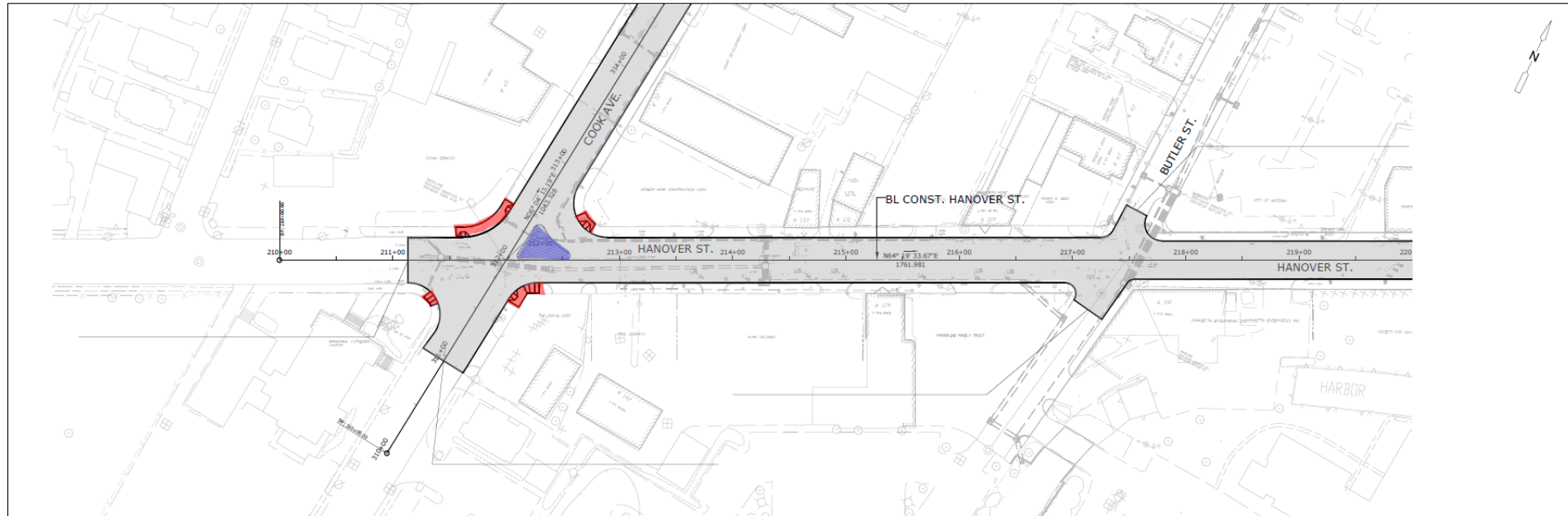

Hanover Street

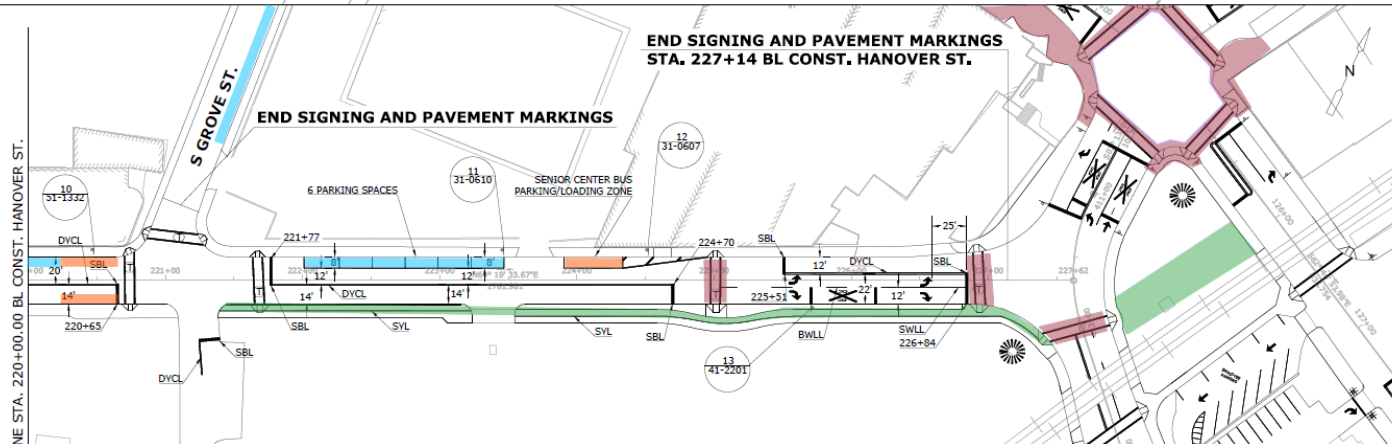
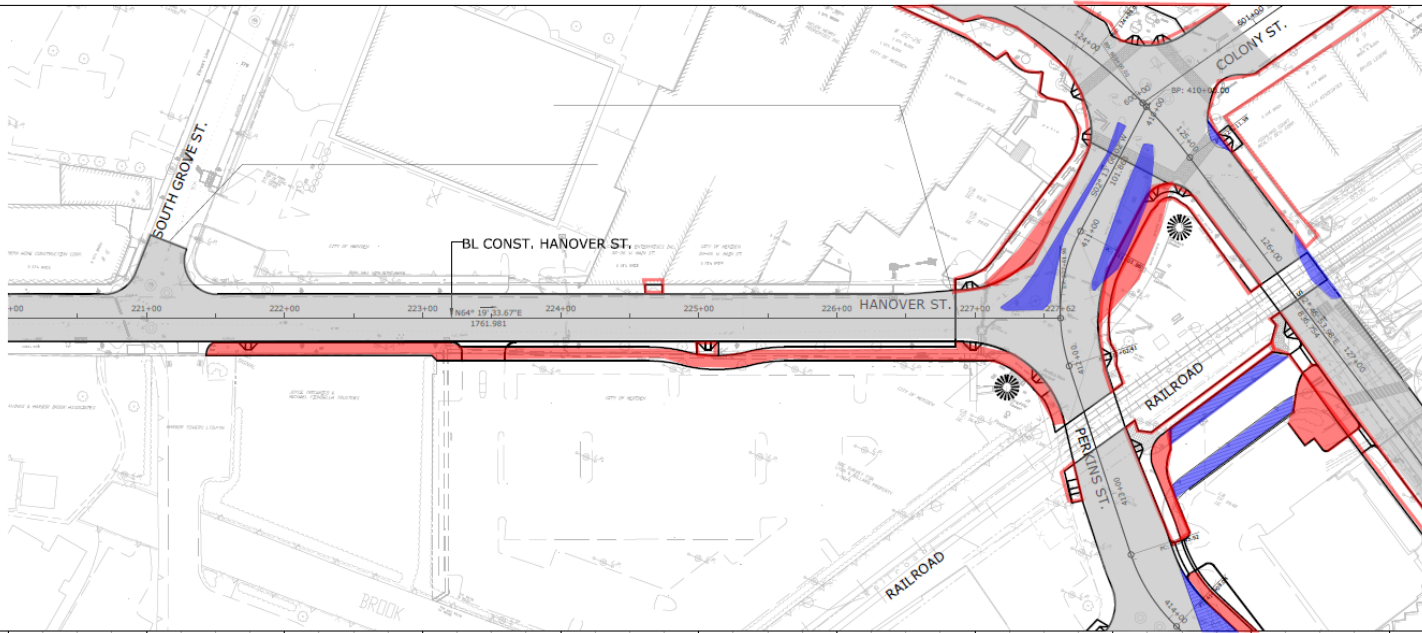

PAVEMENT MARKING LEGEND

- BWLL - 4in BROKEN WHITE LANE LINE
- DWCL - 4in DOUBLE YELLOW CENTER LINE
- SBL - 12in STOP BAR LINE (WHITE)
- SWLL - 4in SOLID WHITE LANE LINE
- SYL - 4in SOLID YELLOW LINE
- WDEL - 4in WHITE DOTTED EXTENSION LINE

NOTES:

- BAR TYPE CROSSWALK TOWN MAINTAINED

Perkins Square

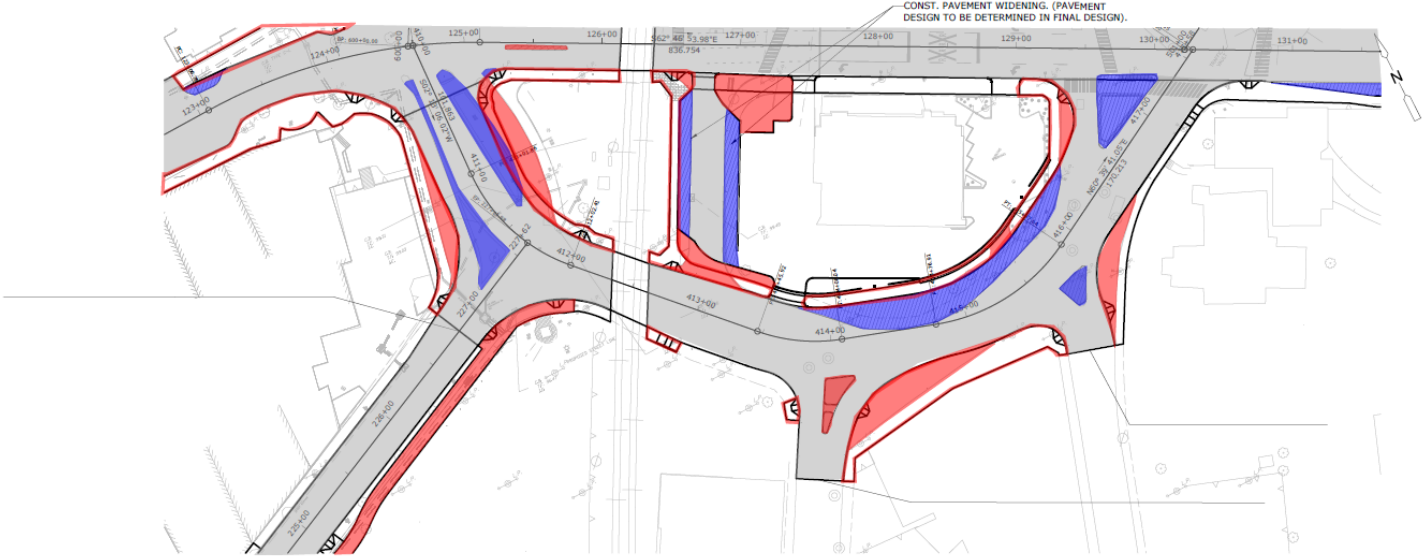

- PAVEMENT MARKING LEGEND**
- BWLL - 4in BROKEN WHITE LANE LINE
 - DYCL - 4in DOUBLE YELLOW CENTER LINE
 - SBL - 12in STOP BAR LINE (WHITE)
 - SWLL - 4in SOLID WHITE LANE LINE
 - SYL - 4in SOLID YELLOW LINE
 - WDEL - 4in WHITE DOTTED EXTENSION LINE

- NOTES:**
- (T) BAR TYPE CROSSWALK TOWN MAINTAINED

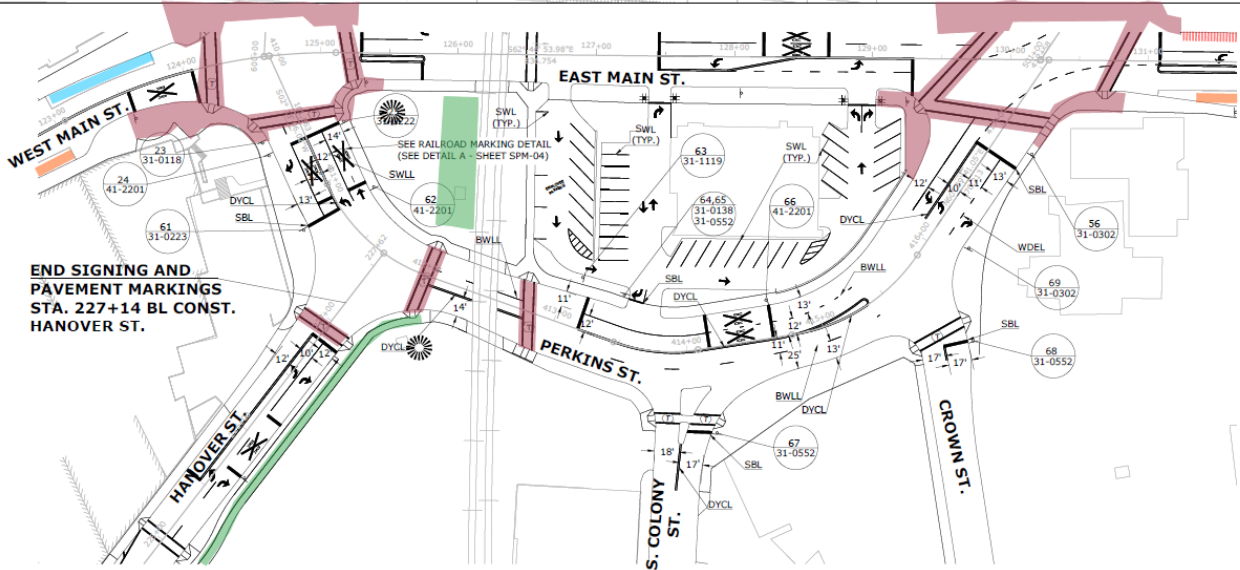

COLONY ST.

PERKINS ST.

Pratt Street

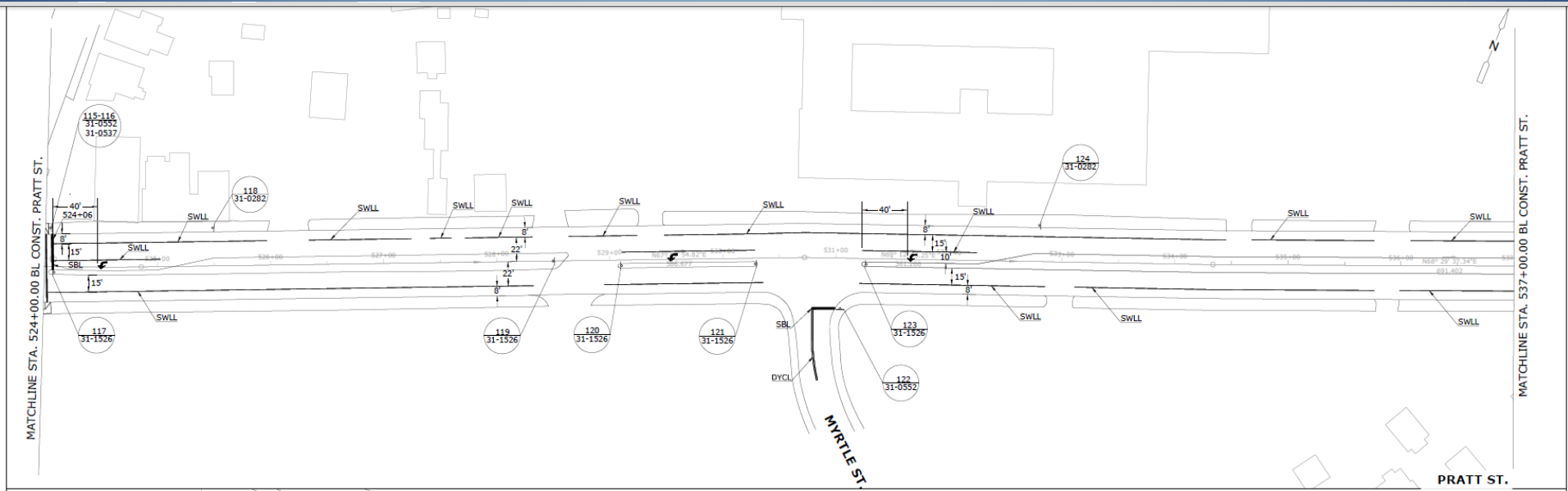
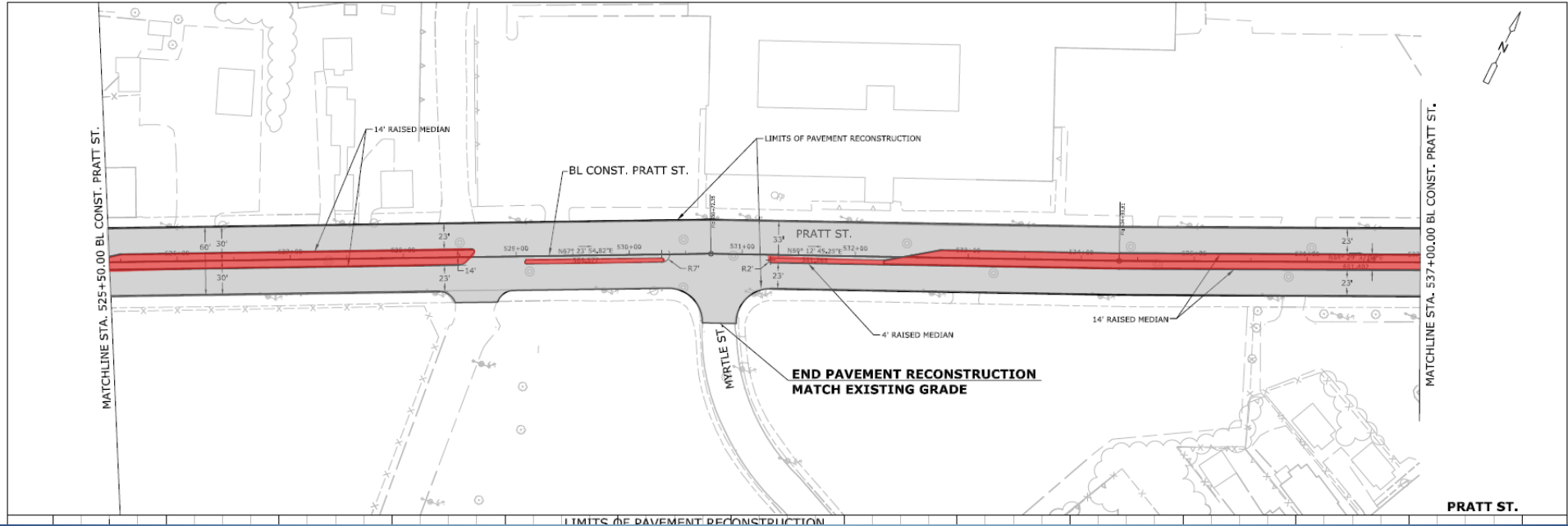

Pratt Street

END PAVEMENT RECONSTRUCTION MATCH EXISTING GRADE

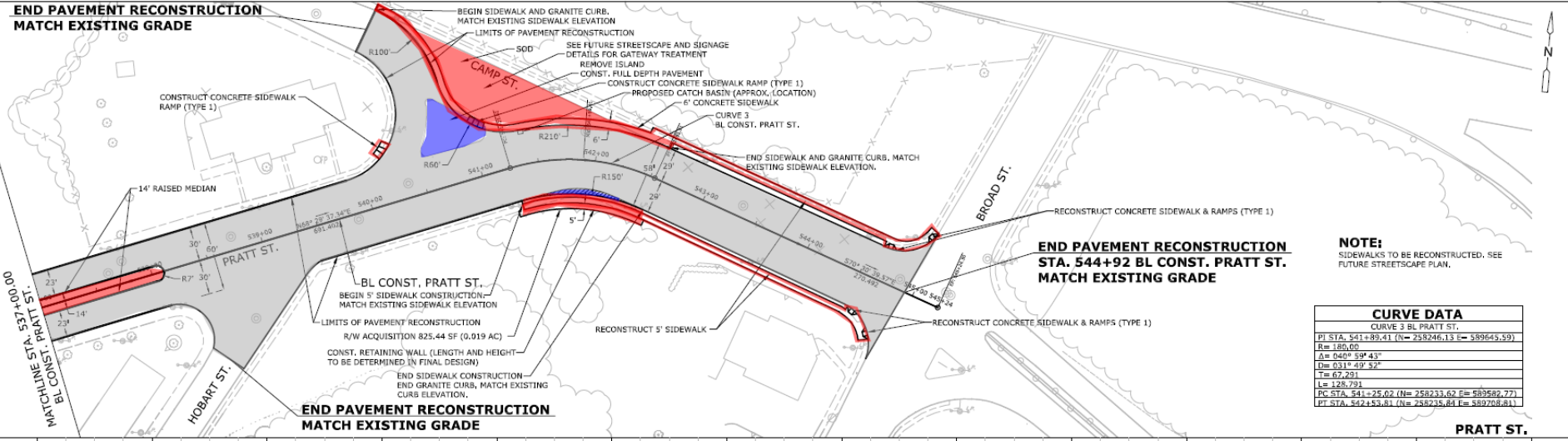

NOTE:
SIDEWALKS TO BE RECONSTRUCTED. SEE FUTURE STREETScape PLAN.

CURVE DATA	
CURVE 3 BL PRATT ST.	
PI STA.	541+89.41 (N= 258246.13 E= 589645.59)
R=	180.00
Δ=	040° 39' 43"
Δ/2=	031° 49' 52"
T=	67.291
L=	125.791
PC STA.	541+25.02 (N= 258233.62 E= 589582.72)
PT STA.	542+53.81 (N= 258235.81 E= 589708.81)

PRATT ST.
PRATT ST.

END SIGNING AND PAVEMENT MARKINGS

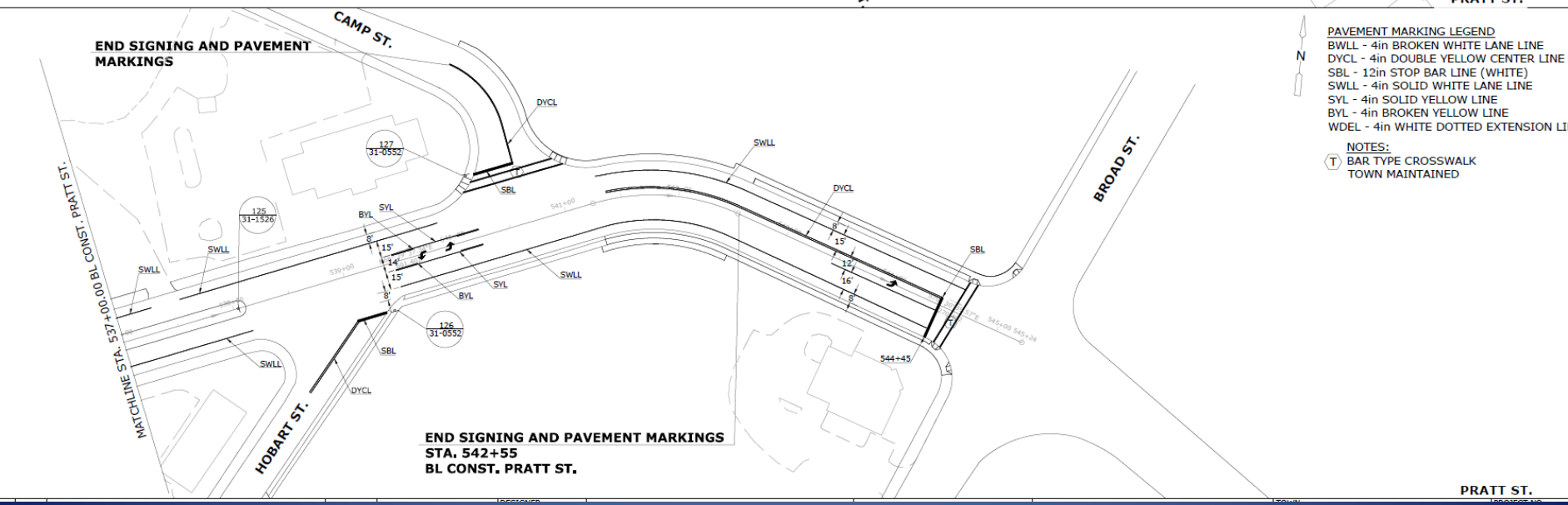

- PAVEMENT MARKING LEGEND**
- BWCL - 4in BROKEN WHITE LANE LINE
 - DYCL - 4in DOUBLE YELLOW CENTER LINE
 - SBL - 12in STOP BAR LINE (WHITE)
 - SWLL - 4in SOLID WHITE LANE LINE
 - BYL - 4in BROKEN YELLOW LINE
 - WDEL - 4in WHITE DOTTED EXTENSION LINE

NOTES:
 BAR TYPE CROSSWALK
 TOWN MAINTAINED

END SIGNING AND PAVEMENT MARKINGS
 STA. 542+55
 BL. 542, PRATT ST.

PRATT ST.

Colony Street

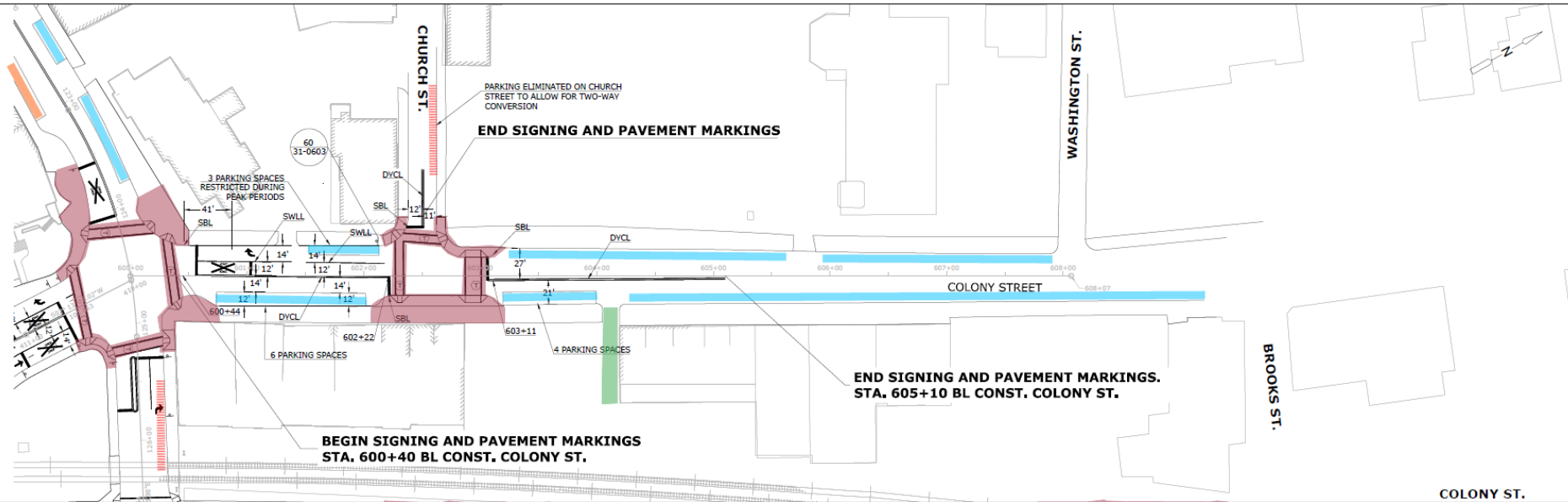
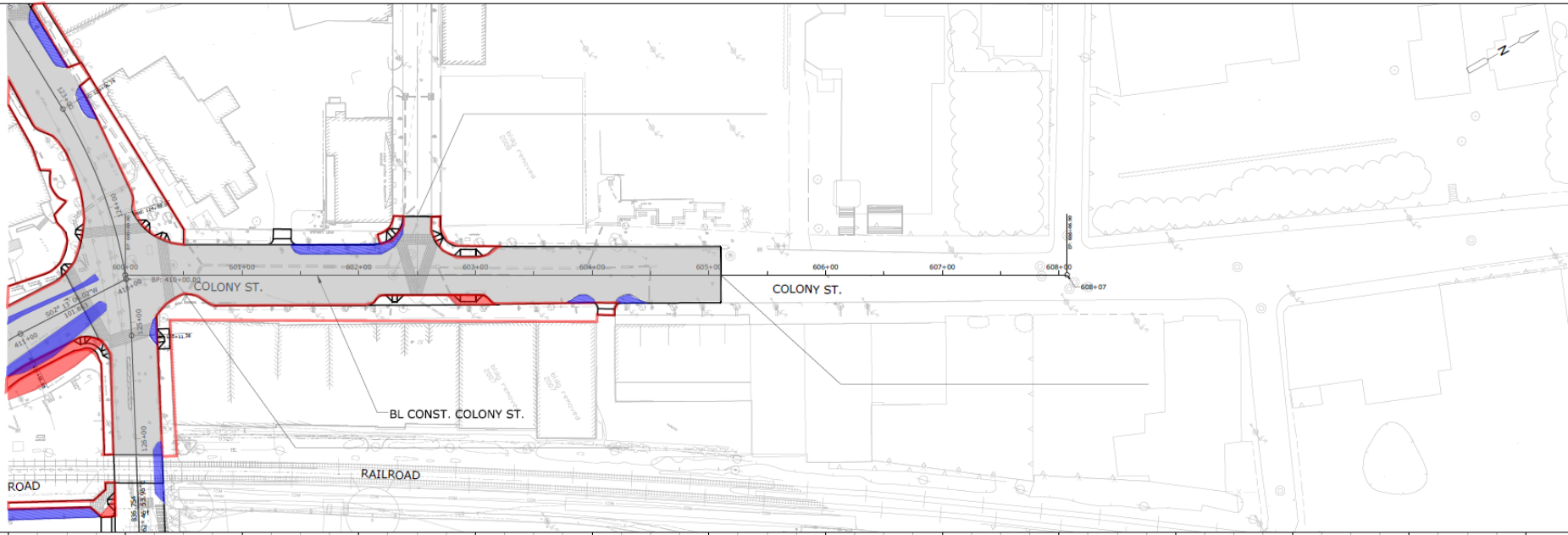



Proposed Improvements

OTHER IMPROVEMENTS

- Church Street
- Barristers Court
- Grove St / South Grove St
- Butler Street
- State Street

MERIDEN

MERIDEN, CONNECTICUT CITY CENTER WAYFINDING

Meriden City Center Wayfinding
Gateway Directional Signs



Alternate Header-2



Alternate Header-1

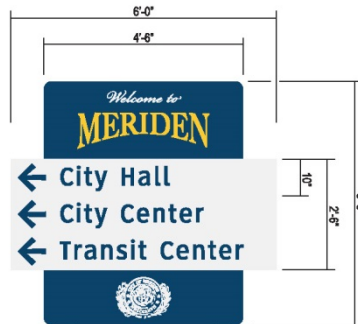

Version 1 - Large

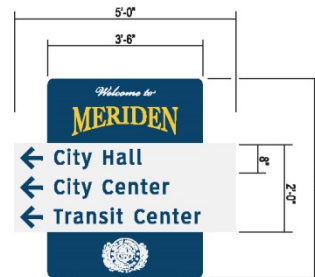

Version 1 - Small



Alternate Header-2



Alternate Header-1

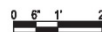

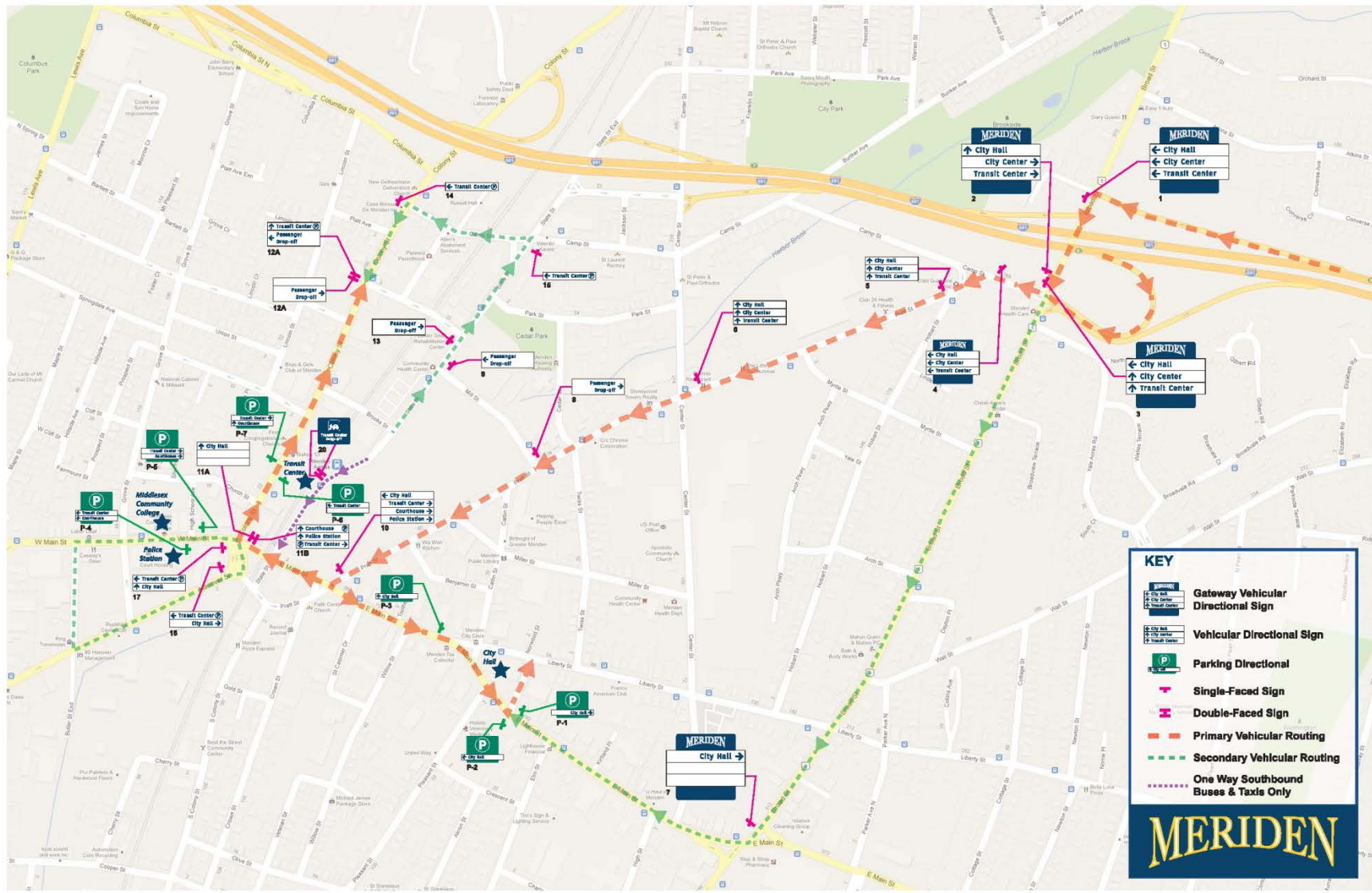

KEY

- Gateway Vehicular Directional Sign**
- Vehicular Directional Sign**
- Parking Directional**
- Single-Faced Sign**
- Double-Faced Sign**
- Primary Vehicular Routing**
- Secondary Vehicular Routing**
- One Way Southbound Buses & Taxis Only**

MERIDEN



Project Phasing – Short Term

- West Main Street
 - Colony Street to Cook Ave
 - Removal of bumpouts
- Colony Street -
 - West Main to Church Street
 - Removal of bumpouts
 - Pedestrian enhancements at Colony St and Church St



Project Phasing – Short Term

- East Main Street – Pratt St to St Casimer Dr
 - Bus stop at St Casimer Dr
- Cook Ave – Hanover St to West Main St
 - Conversion from one-way to two way traffic
- Church Street – Colony St to Barristers Court
 - Conversion from one-way to two way traffic
 - Better access to parking garage



Project Phasing – Long Term

- State Street – State Project
 - Hanover Street – Cook St to Colony St
 - Pratt Street – East Main St to Broad St
 - Perkins Square
 - West Main Street – Colony St to Cook Ave
 - East Main Street
- 

Funding

- Sources
 - Bonds
 - Grants
 - Nationally Competitive
TIGER
 - Regional Council of Governments
 - Routine Capital Improvements
 - Paving
 - Sidewalks

Looking Forward

- Address comments, questions and concerns regarding this plan
- Finalize part or all of the design work
- Explore and secure funding for project phases
- Coordinate construction activities with the businesses to minimize impacts

Question and Answer

- General – Whole Audience
- Specific – Separate Sections

